

Filtrate Gutter Guard Installation Guide

Contents	Page
Tools to use.	2
Roofs and Gutters Filtrate Gutter Guard installs on.	2
Installing Filtrate Gutter Guard basics.	3
Installing Filtrate Gutter Guard on outside corners.	4
Installing Filtrate Gutter Guard on inside corner gutter.	5
Covering the opening at the end of a gutter	6
Maintaining Filtrate Gutter Guard.	6
Ladder Safety	7

Tools You May Need



Drill



Any type of tin snip



Crowbar



Step Ladder

Types of Gutters Filtrate Gutter Guard Installs On

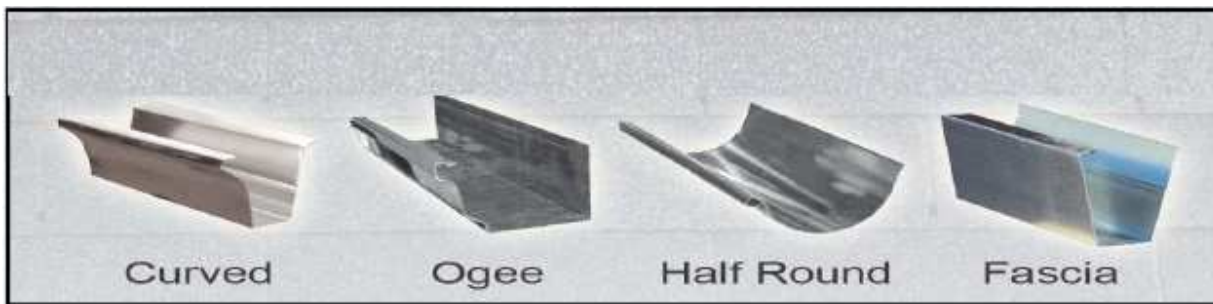

Types of Roofs Filtrate Gutter Guard Installs On



Filtrate Gutter Guard can also install on the following other roof types:

- Stone coated steel
- Corrugated metal
- Standing lock metal seam
- Flat roofs



Installing Filtrate Gutter Guard Basics



Installing Filtrate Gutter Guard sections: Install directly under the shingle (A). Careful not to damage shingles when lifting them up.



Adjoining sections together: When putting one section next to another section, the mesh overlaps the end of each section by about 1cm (B) onto the adjacent section of Filtrate Gutter Guard. Trim off this small piece (C), so it lays evenly (D).

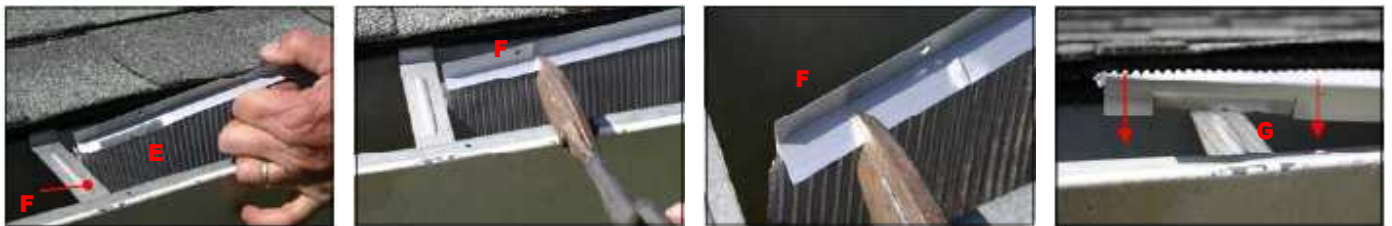

Gutter Bracket: On rare occasions, the gutter support bracket may sit too high (E), if so, cut the underside of Filtrate Gutter Guard (F) and bend it back slightly to make room for the bracket (G).



Screwing: Use drill to screw in 3 self-tapping screws for each 122cm section (H). Each section already has 3 pre-drilled holes for the screw. However, the screws are self-tapping(I), if you wanted to put a screw where there is no pre-drilled hole.



Cutting: Use tin snips to cut mesh (J). Cut front edge (K). Cut bottom leg (L). Grasp section with tin snips or hand and snap off (M).

Installing Filtrate Gutter Guard on Outside Corner Gutter



Use 2 pieces of Filtrate Gutter Guard.



Trim Filtrate Gutter Guard at angle of roof.



If shingles are sticking at the corner, you can use the crowbar tool very carefully to lift shingle up (N).



Trim other piece of Filtrate Gutter Guard.



Screw both pieces to front of gutter.



Screw down the corner fastener over the joint of both sections of Filtrate Gutter Guard.



Installing Filtrate Gutter Guard on Inside Corner Gutter



Use 2 pieces of Filtrate Gutter Guard. Slide Filtrate Gutter Guard flush to the back of the gutter (O). Open space (P) needs to be covered.



Extend Filtrate Gutter Guard over about 5cm (Q). Cut the front and underside (R) of the aluminum drip edge and then snap it off (S).



Pull piece of aluminum off mesh (T). Bend mesh down into gutter (U). Trim back mesh so it fits in gutter (V).



Bend mesh back (W). Put piece of Filtrate Gutter Guard on gutter and slide over (X). The open space (P) is now covered (Y).

Covering the Opening at the End of the Gutter

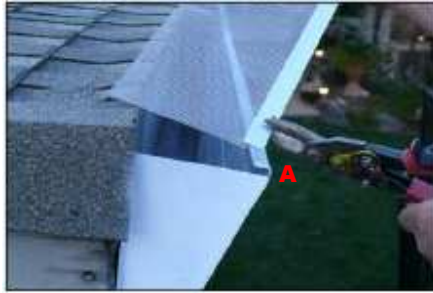
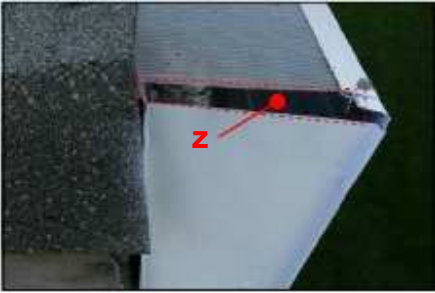

When installing Filtrate Gutter Guard at the end of the gutter, there is an opening (Z) that should be covered. Cut a small section of the aluminum off. Start by cutting part of the front (A). Also cut the bottom leg (B), this will make it easier to snap off.

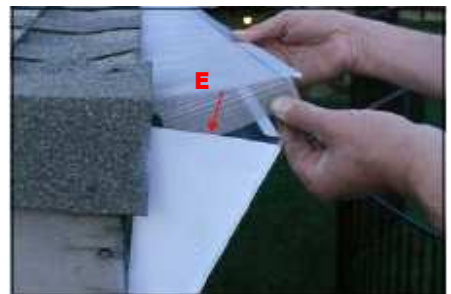
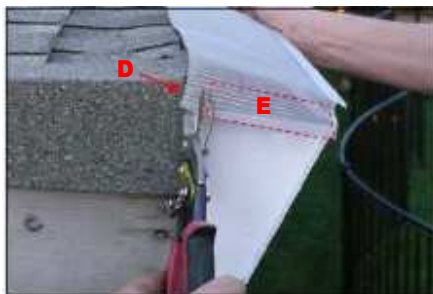

Carefully pull the aluminum piece off the mesh (C). Trim back the mesh (D) so the other section of mesh will fit in the gutter (E).

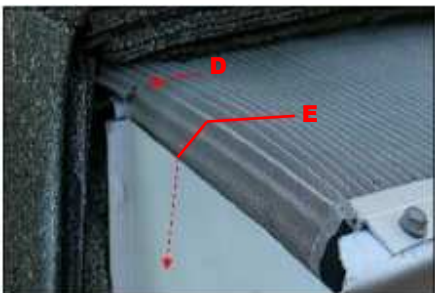

You see where the mesh was trimmed back (D) so the other piece of mesh (E) slides down inside the end of the gutter. This closes off the opening to keep leaves, pine needles, rodents and large insects out of the your gutter.

Maintaining Filtrate Gutter Guard



Filtrate Gutter Guard, like any other gutter protection system, from time to time can also have debris build up on top of itself on an inside miter or simulated miter of your roof where organic debris can collect more easily. If debris collects to the point where rainwater drips off, then use a brush on the end of an extension pole, and from the ground, you can easily brush off the debris without getting on the roof.

Basic Ladder Safety Tips

These safety tips are not intended to be a guarantee that you won't have an accident, but are preventative measures that can be taken to reduce the risk of falls. This is not intended to be an all inclusive guidelines of all ladder safety issues.

1. Make sure you have the right ladder for the job:

- Use a ladder, not a chair or box, to reach heights for installing Filtrate Gutter Guard. Before using a ladder, make sure that you are fully trained on how to use it. The ladder should be:
- The ladder should be rated tall enough to reach the gutter or roof.
- The ladder should be rated to handle the combined weight of you, your tools and any materials you are carrying.

2. Inspect and evaluate every ladder before using it:

Don't use a ladder that has any missing or broken parts, ... Throw it away!

A ladder should have:

- No missing parts.
- Firmly attached slip resistant steps, rungs, or cleats free of grease or oil.
- Tight support braces, bolts, screws, and spreaders.
- Lubricated metal parts.
- Safety feet.
- No splinters or sharp edges and no dents or bent parts in metal ladders.

3. Set up the ladder properly for which it is intended:

- Place it on a level floor or ground, with the legs parallel to the surface it rests against which would be the gutter or roof edge.
- Step on the first rung, shift your weight around to see if any ladder legs sink into a hidden pot hole.
- Place the ladder on strong wood boards/plywood if the ground is unstable.
- Extend the ladder at least three feet above the top support (roof or gutter).
- Don't rest it on a window or door.

4. Climb and work on ladders safely:

- Wear shoes with clean, nonskid, non-leather soles.
- Allow only one person on a ladder at a time.
- Climb up and down facing the ladder and holding both side rails.
- Carry tools on a belt or rope or hoist.
- Work with at least one hand on the ladder.
- Move slowly and cautiously on a ladder.
- Don't move a ladder while you're on it.

