



New Tech Machinery

A MAZZELLA COMPANY

Innovation. Quality. Versatility.

The World's Finest Portable Rollforming Equipment



BG7™

7" Commercial Box Gutter Machine

www.GutterSupply.com

1-888-909-RAIN

Info@GutterSupply.com

BG7™ Box Gutter Machine

7" Commercial Box Gutter Machine

- Two Profiles ... One Machine!
- The solution to your industrial gutter needs!



Note: Machine shown with optional equipment

STANDARD FEATURES

Polyurethane Drive Rollers	Length Control Limit Switch
Hydraulic Drive & Shear	Power Interruption Safety Circuit
Push Button RUN/JOG Controls at Entry & Exit Ends	Welded Tubular Steel Frame
Choice of: Quick-Change Power-Pack™ - Gas or Electric	Runs up to 22 Ga. Material
Gutter Recognition Safety System	Industry's Best Warranty

SPECIFICATIONS

BG7 GUTTER MACHINE	
Length	17' 10" (5.4m)
Width	4' (1.2m)
Height	4' 3" (1.3m) with Over Head Rack 2' 8" (.8m) without Over Head Rack
Weight	3,000 lbs. (1,370kg)
BG7 ON TRAILER	
Length	21' (6.4m)
Width	7' (2.1m)
Height	6' 3" (1.9m) with Reel
Weight	5,200 lbs. (2,370kg)
COIL WIDTH	
20" (508mm) - Straight Back, HK7 Hook	
MATERIALS FORMED	
Painted Steel	26 ga. to 22 ga. (.4mm to .8mm) (painted, galvanized, aluminized)
Painted Aluminum	.032" to .050" (.8mm to 1.3mm)
Copper	20 oz. to 24 oz. 3/4 Hard (.7mm to .8mm)
SHEAR	
Hydraulically Powered, Hardened Tool Steel Blades & Shear Dies	
Gutter Recognition Safety System	
DRIVE	
Hydraulically Driven Polyurethane Rollers	
SPEED	
60 ft./min (18m/min) Approx.	

BG7 Panel Profiles *(Choice of)*

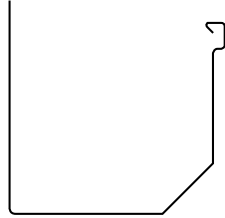
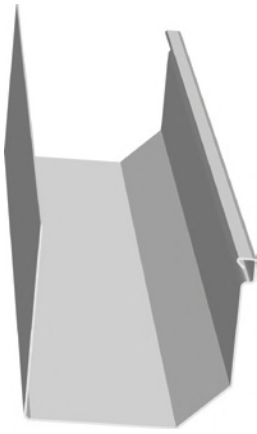

**GUTTER WITH
STRAIGHT BACK**

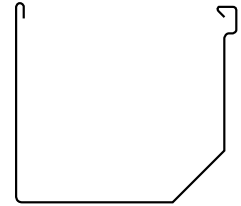
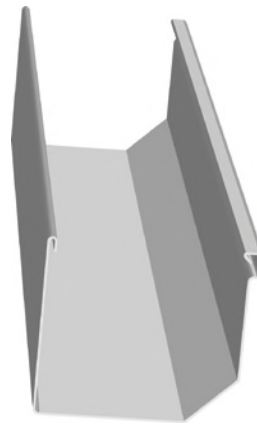

**GUTTER WITH
HOOK**

Warranty:

- Three years parts (including electrical) / Three years labor
- Limited lifetime separation on drive rollers
- Limited lifetime on stainless steel forming rollers

U.S. PATENT NO. 5,394,722

Optional Equipment *See Website for More Options.*



**MACHINE WITH
COVER**

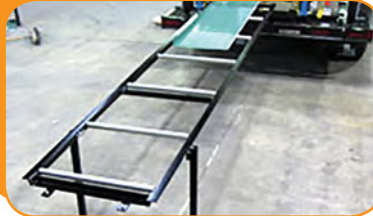

**RUN OUT TABLE
(10' SECTIONS)**



**PLC07 COMPUTER
CONTROLLER**



**EXPANDABLE
ARBOR / REEL**



**QUICK-CHANGE POWER-PACK™
(GAS OR ELECTRIC)**



**FOUR-BUTTON REMOTE CONTROL
(START, STOP, FWD & REV)**